

**West Norriton Township  
Zoning Hearing Board  
Hearing No. 911  
7:00 PM**

1. Application For Natale (112 Worthington Circle)

Documents:

[SKM\\_C45821091015410.PDF](#)

**[www.westnorritontwp.org](http://www.westnorritontwp.org)**



APPLICATION TO THE ZONING HEARING BOARD OF WEST NORRITON TOWNSHIP UNDER CHAPTER 27-1801 OF THE CODE OF ORDINANCES

Application is made this 26th day of July 2021 by the undersigned for a special exception or variance from the terms of the Revised General Ordinances of West Norriton Township and amendments thereto.

1. The name of this applicant is Anthony and Danielle Natale whose address is 112 Worthington Circle, Norristown, PA 19463

2. The owner of the real estate affected by the proposed exception or variance is Anthony and Danielle Natale whose address is 112 Worthington Circle, Norristown, Pa 19463 and who has joined in this application.

3. A brief description and location of the real estate to be affected by such proposed change is as follows: 112 Worthington Circle, Norristown, PA 19463 located in Montgomery County, West Norriton Twp.

4. The real estate in question is classified under Class R-2. That at present it is used for the purpose of Recreation and the improvements consist of installing a granite inground swimming pool asking for a variance to allow for 10' offset from the pool to the property line where 20' is required

5. Applicant claims that the variance or exception herein requested may be allowed under Section 2021-275D Sub-Section of the Revised General Ordinances of West Norriton Township.

6. The variance or exception requested and the new improvements or additions to old improvements desired to be made are as follows:  
(Note: Set forth a reasonably accurate description of the present improvements and the additions intended to be made under this application, indicating the size of such proposed improvements, material, and general construction thereof).

Attached hereto is a plot plan of the real estate affected, indicating the location and size of the lot, and size of improvements now erected and proposed to be erected thereon.

7. Applicant believes that the exceptions or variance should be granted for the following reasons:

STATE OF PENNSYLVANIA :ss  
COUNTY OF MONTGOMERY

CHESTER

Rosalinda S. Klunk

being duly sworn according to law, deposes and says that the facts above set forth are true and correct.

Sworn to and subscribed before me

this 12<sup>th</sup> day of August 19 2021

Rosalinda S. Klunk

Notary Public

[Signature]

Applicant

[Signature]

Owner

Commonwealth of Pennsylvania - Notary Seal  
Rosalinda S. Klunk, Notary Public  
Chester County  
My commission expires September 5, 2022  
Commission number 1192553  
Member, Pennsylvania Association of Notaries

(SEAL)

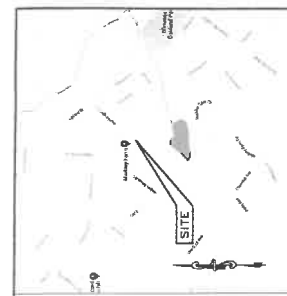

**SECTION AND SEWAGE CONTROL NOTES**

1. ALL SECTIONS SHALL BE CONFORMED TO THE REQUIREMENTS OF THE PENNSYLVANIA DEPARTMENT OF ENVIRONMENTAL PROTECTION (PA DEP) AND THE LOCAL AND STATE REQUIREMENTS.

2. ALL LINES SHOWN SHALL BE INSTALLED PRIOR TO THE START OF CONSTRUCTION.

3. ALL TRENCHES SHALL BE INSTALLED TO THE DEPTH INDICATED ON THE DRAWING AND SHALL BE PROTECTED FROM DAMAGE BY TRAFFIC.

4. ALL TRENCHES SHALL BE INSTALLED TO THE DEPTH INDICATED ON THE DRAWING AND SHALL BE PROTECTED FROM DAMAGE BY TRAFFIC.

5. ALL TRENCHES SHALL BE INSTALLED TO THE DEPTH INDICATED ON THE DRAWING AND SHALL BE PROTECTED FROM DAMAGE BY TRAFFIC.

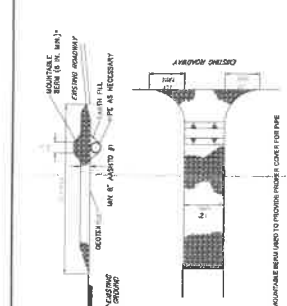

**SEEDING SPECIFICATIONS**

1. SEEDING SHALL BE DONE TO THE SATISFACTION OF THE LOCAL AND STATE REQUIREMENTS.

2. ALL SEEDING SHALL BE DONE TO THE SATISFACTION OF THE LOCAL AND STATE REQUIREMENTS.

3. ALL SEEDING SHALL BE DONE TO THE SATISFACTION OF THE LOCAL AND STATE REQUIREMENTS.

4. ALL SEEDING SHALL BE DONE TO THE SATISFACTION OF THE LOCAL AND STATE REQUIREMENTS.

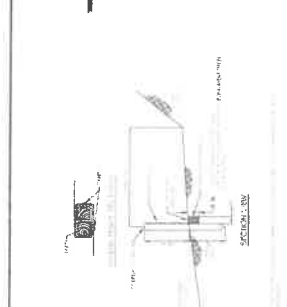

**SEEDING SPECIFICATIONS**

1. SEEDING SHALL BE DONE TO THE SATISFACTION OF THE LOCAL AND STATE REQUIREMENTS.

2. ALL SEEDING SHALL BE DONE TO THE SATISFACTION OF THE LOCAL AND STATE REQUIREMENTS.

3. ALL SEEDING SHALL BE DONE TO THE SATISFACTION OF THE LOCAL AND STATE REQUIREMENTS.

4. ALL SEEDING SHALL BE DONE TO THE SATISFACTION OF THE LOCAL AND STATE REQUIREMENTS.

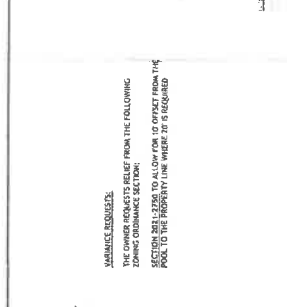

**TEMPORARY TOPSOIL STOCKPILE**

1. FENCE TO BE PLACED TO PREVENT EROSION OF MATERIALS AND TO PREVENT MATERIALS FROM BEING WASHED AWAY BY RAIN.

2. ALL STOCKPILES SHALL BE COVERED WITH MULCH OR A SIMILAR EROSION CONTROL MEASURE.

3. ALL STOCKPILES SHALL BE COVERED WITH MULCH OR A SIMILAR EROSION CONTROL MEASURE.

4. ALL STOCKPILES SHALL BE COVERED WITH MULCH OR A SIMILAR EROSION CONTROL MEASURE.

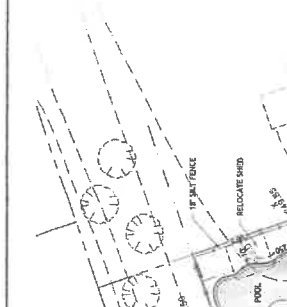

**SEWAGE DETAIL**

1. SEWAGE SHALL BE TREATED TO THE SATISFACTION OF THE LOCAL AND STATE REQUIREMENTS.

2. ALL SEWAGE SHALL BE TREATED TO THE SATISFACTION OF THE LOCAL AND STATE REQUIREMENTS.

3. ALL SEWAGE SHALL BE TREATED TO THE SATISFACTION OF THE LOCAL AND STATE REQUIREMENTS.

4. ALL SEWAGE SHALL BE TREATED TO THE SATISFACTION OF THE LOCAL AND STATE REQUIREMENTS.

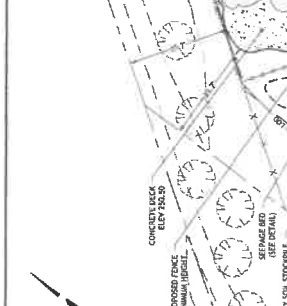

**IMPERVIOUS COVERAGE**

1. IMPERVIOUS SURFACE SHALL BE CONSTRUCTED TO THE SATISFACTION OF THE LOCAL AND STATE REQUIREMENTS.

2. ALL IMPERVIOUS SURFACES SHALL BE CONSTRUCTED TO THE SATISFACTION OF THE LOCAL AND STATE REQUIREMENTS.

3. ALL IMPERVIOUS SURFACES SHALL BE CONSTRUCTED TO THE SATISFACTION OF THE LOCAL AND STATE REQUIREMENTS.

4. ALL IMPERVIOUS SURFACES SHALL BE CONSTRUCTED TO THE SATISFACTION OF THE LOCAL AND STATE REQUIREMENTS.

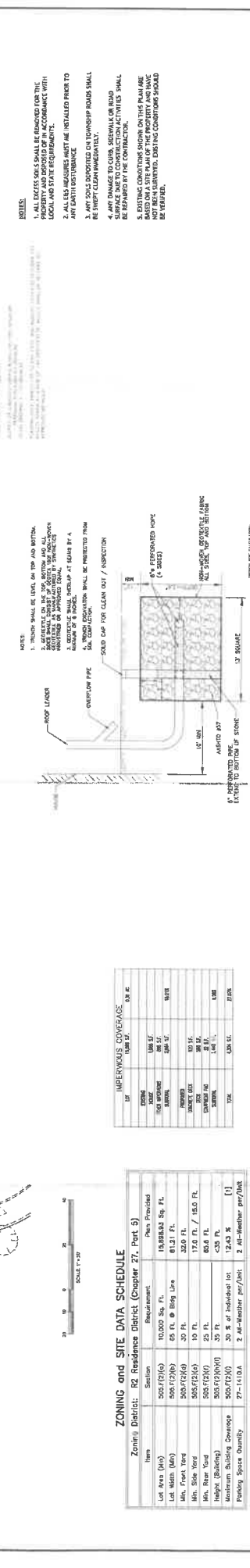

**112 WORTHINGTON CIRCLE**

**PROPOSED GRADING PLAN**

**CIVIL ENGINEERING CONSULTANTS**

**AWA ENGINEERING LLC**  
 1711 MARKET LANE  
 HARRISBURG, PA 17110  
 (717) 633-1100  
 www.civilengineer.com

**LOCATED IN:**  
 WEST HERRINGTON TWP  
 MONROE COUNTY  
 PENNSYLVANIA

**DATE:** 06/11/21  
**SCALE:** 1" = 20'  
**DRAWN BY:** WMA  
**JOB #:** 2106271-06  
**SHEET:** 1 OF 1

**NOTES:**

1. ALL SECTIONS SHALL BE CONFORMED TO THE REQUIREMENTS OF THE PENNSYLVANIA DEPARTMENT OF ENVIRONMENTAL PROTECTION (PA DEP) AND THE LOCAL AND STATE REQUIREMENTS.
2. ALL LINES SHOWN SHALL BE INSTALLED PRIOR TO THE START OF CONSTRUCTION.
3. ALL TRENCHES SHALL BE INSTALLED TO THE DEPTH INDICATED ON THE DRAWING AND SHALL BE PROTECTED FROM DAMAGE BY TRAFFIC.
4. ALL TRENCHES SHALL BE INSTALLED TO THE DEPTH INDICATED ON THE DRAWING AND SHALL BE PROTECTED FROM DAMAGE BY TRAFFIC.
5. ALL TRENCHES SHALL BE INSTALLED TO THE DEPTH INDICATED ON THE DRAWING AND SHALL BE PROTECTED FROM DAMAGE BY TRAFFIC.
6. ALL TRENCHES SHALL BE INSTALLED TO THE DEPTH INDICATED ON THE DRAWING AND SHALL BE PROTECTED FROM DAMAGE BY TRAFFIC.
7. ALL TRENCHES SHALL BE INSTALLED TO THE DEPTH INDICATED ON THE DRAWING AND SHALL BE PROTECTED FROM DAMAGE BY TRAFFIC.
8. ALL TRENCHES SHALL BE INSTALLED TO THE DEPTH INDICATED ON THE DRAWING AND SHALL BE PROTECTED FROM DAMAGE BY TRAFFIC.
9. ALL TRENCHES SHALL BE INSTALLED TO THE DEPTH INDICATED ON THE DRAWING AND SHALL BE PROTECTED FROM DAMAGE BY TRAFFIC.
10. ALL TRENCHES SHALL BE INSTALLED TO THE DEPTH INDICATED ON THE DRAWING AND SHALL BE PROTECTED FROM DAMAGE BY TRAFFIC.
11. ALL TRENCHES SHALL BE INSTALLED TO THE DEPTH INDICATED ON THE DRAWING AND SHALL BE PROTECTED FROM DAMAGE BY TRAFFIC.
12. ALL TRENCHES SHALL BE INSTALLED TO THE DEPTH INDICATED ON THE DRAWING AND SHALL BE PROTECTED FROM DAMAGE BY TRAFFIC.
13. ALL TRENCHES SHALL BE INSTALLED TO THE DEPTH INDICATED ON THE DRAWING AND SHALL BE PROTECTED FROM DAMAGE BY TRAFFIC.
14. ALL TRENCHES SHALL BE INSTALLED TO THE DEPTH INDICATED ON THE DRAWING AND SHALL BE PROTECTED FROM DAMAGE BY TRAFFIC.
15. ALL TRENCHES SHALL BE INSTALLED TO THE DEPTH INDICATED ON THE DRAWING AND SHALL BE PROTECTED FROM DAMAGE BY TRAFFIC.
16. ALL TRENCHES SHALL BE INSTALLED TO THE DEPTH INDICATED ON THE DRAWING AND SHALL BE PROTECTED FROM DAMAGE BY TRAFFIC.
17. ALL TRENCHES SHALL BE INSTALLED TO THE DEPTH INDICATED ON THE DRAWING AND SHALL BE PROTECTED FROM DAMAGE BY TRAFFIC.
18. ALL TRENCHES SHALL BE INSTALLED TO THE DEPTH INDICATED ON THE DRAWING AND SHALL BE PROTECTED FROM DAMAGE BY TRAFFIC.
19. ALL TRENCHES SHALL BE INSTALLED TO THE DEPTH INDICATED ON THE DRAWING AND SHALL BE PROTECTED FROM DAMAGE BY TRAFFIC.
20. ALL TRENCHES SHALL BE INSTALLED TO THE DEPTH INDICATED ON THE DRAWING AND SHALL BE PROTECTED FROM DAMAGE BY TRAFFIC.

**CALL BEFORE YOU DIG:**  
 PENNSYLVANIA LAW REQUIRES 3 WORKING DAYS NOTICE FOR CONSTRUCTION PHASE AND 10 STAGE-STOP CALL PENNSYLVANIA ONE CALL SYSTEM, INC.  
 1-800-242-1776