

LEGEND

EXISTING	
	CURB
	EDGE OF PAVE
	ABUTTER PROPERTY LINES
	PROJECT PARCEL PROPERTY LINES
	EASEMENT
	GAS LINE
	SHRUB
	DECIDUOUS TREE
	CONIFEROUS TREE
	LIGHT STANDARD
	CONCRETE
PROPOSED	
	CURB
	EDGE OF PAVE
	PARTIAL-DEPTH ASPHALT PAVING
	FULL-DEPTH ASPHALT PAVING
	ASPHALT PATH PAVING
	CONCRETE
	DETAIL 4 ON SHEET 7

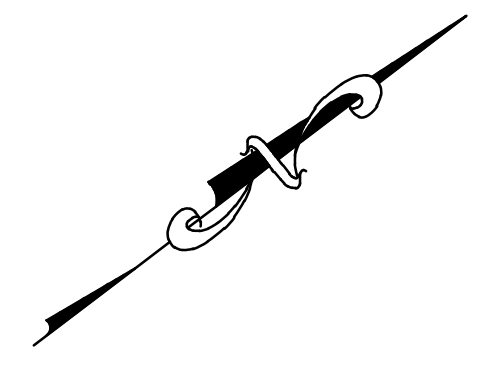
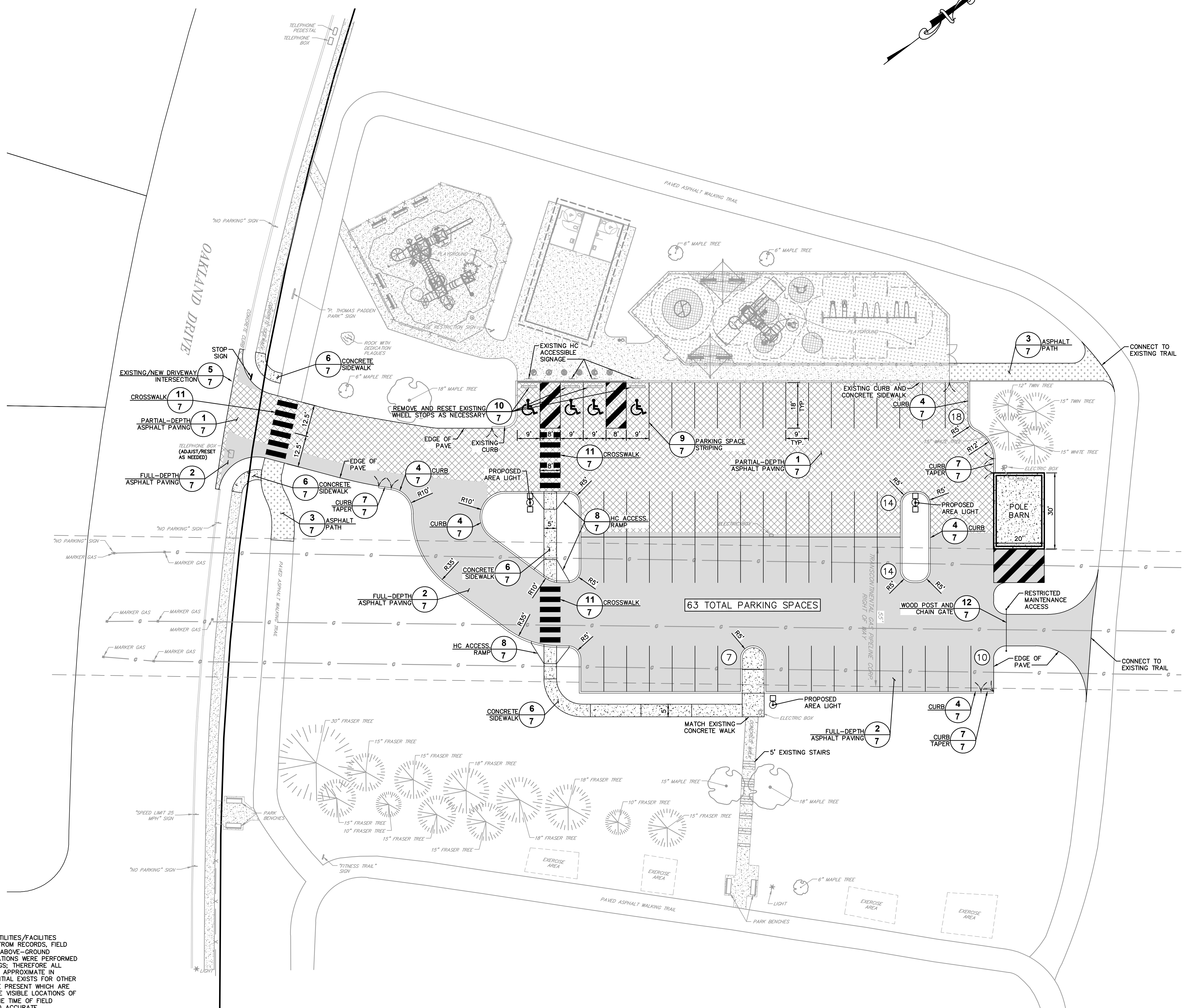

G:\MUNICIPAL\2020\2020-01-15-WNT_Padden Park_VESIGN\CAD\Parking Lot_Site Improvements Plan Plotted By: batulder, on Mon Mar 15, 2021 at 2:53pm

PENNSYLVANIA ONE CALL SYSTEM, INC.
 925 Irish Run Road
 West Mifflin, Pennsylvania
 15122 - 1078

BEFORE YOU DIG ANYWHERE IN PENNSYLVANIA CALL 1-800-242-1776
 NON-MEMBERS MUST BE CONTACTED DIRECTLY
 PA LAW REQUIRES THREE WORKING DAYS NOTICE TO UTILITIES BEFORE YOU EXCAVATE, DRILL, BLAST OR DEMOLISH
 SERIAL NO. 20200452320

LOCATIONS OF EXISTING UNDERGROUND UTILITIES/FACILITIES SHOWN HEREON HAVE BEEN DEVELOPED FROM RECORDS, FIELD MARKOUTS BY UTILITY OWNERS, AND/OR ABOVE-GROUND OBSERVATION OF THE SITE. NO EXCAVATIONS WERE PERFORMED IN THE PREPARATION OF THESE DRAWINGS; THEREFORE ALL UTILITIES SHOWN SHOULD BE CONSIDERED APPROXIMATE IN LOCATION, DEPTH, AND SIZE. THE POTENTIAL EXISTS FOR OTHER UNDERGROUND UTILITIES/FACILITIES TO BE PRESENT WHICH ARE NOT SHOWN ON THE DRAWINGS. ONLY THE VISIBLE LOCATIONS OF UNDERGROUND UTILITIES/FACILITIES AT THE TIME OF FIELD SURVEY SHALL BE CONSIDERED TRUE AND ACCURATE. COMPLETENESS OR ACCURACY OF UNDERGROUND UTILITIES/FACILITIES ARE NOT GUARANTEED BY GILMORE & ASSOCIATES, INC.

ALL CONTRACTORS WORKING ON THIS PROJECT SHALL VERIFY LOCATION AND DEPTH OF ALL UNDERGROUND UTILITIES/FACILITIES PRIOR TO START OF WORK AND SHALL COMPLY WITH THE REQUIREMENTS OF P.L. 852, NO. 287 DECEMBER 10, 1974 AS LAST AMENDED ON APRIL 28, 2018 PENNSYLVANIA ACT 50. GILMORE & ASSOCIATES, INC. HAS OBTAINED A PA-ONE CALL SERIAL NUMBER AS NOTED HEREON FOR DESIGN PURPOSES ONLY.

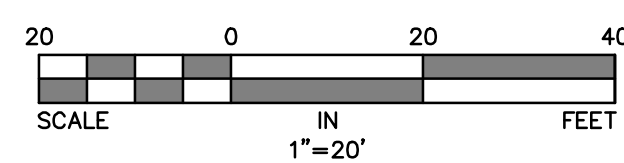

GILMORE & ASSOCIATES, INC.
 ENGINEERING & CONSULTING SERVICES

100 NEW BRUNSWICK AVENUE SUITE 100, NEW BRUNSWICK, NJ 08901-2500 • P: 908.334.4300 • www.gilmoreinc.com

ONLY THOSE PLANS INCORPORATING THE PROFESSIONAL SEAL SHOULD BE CONSIDERED OFFICIAL AND RELIED UPON BY USER. THIS PLAN IS THE PROPERTY OF GILMORE & ASSOCIATES, INC. NO REPRODUCTION, MODIFICATION, REVISION, DUPLICATION OR USE, WITHOUT THE CONSENT OF GILMORE & ASSOCIATES, INC. IS PROHIBITED.
 © COPYRIGHT 2021 GILMORE & ASSOCIATES, INC. ALL RIGHTS RESERVED.

SITE IMPROVEMENT PLAN
PADDEN PARK - PARKING LOT
 WEST NORRITON TOWNSHIP, MONTGOMERY COUNTY, PENNSYLVANIA

DATE: _____ BY: _____
 DESCRIPTION: _____
 REV: _____

SITE IMPROVEMENTS PLAN

SHEET NO.:
3 OF 7