

LEGEND

- 20--- EXISTING MAJOR CONTOURS
- 19--- EXISTING MINOR CONTOURS
- EXISTING PAVEMENT EDGE
- 1" & TREE EXISTING TREES
- S EXISTING SANITARY
- W EXISTING WATER
- X X EXISTING STORM
- X X EXISTING FENCE
- EXISTING TREELINE
- EXISTING STORM MANHOLE
- EXISTING SANITARY MANHOLE
- EXISTING ELECTRIC METER
- EXISTING ELECTRIC BOX
- EXISTING STORM INLET
- * EXISTING LIGHT
- EXISTING UTILITY POLE
- EXISTING TREE STUMP
- EXISTING SHRUB

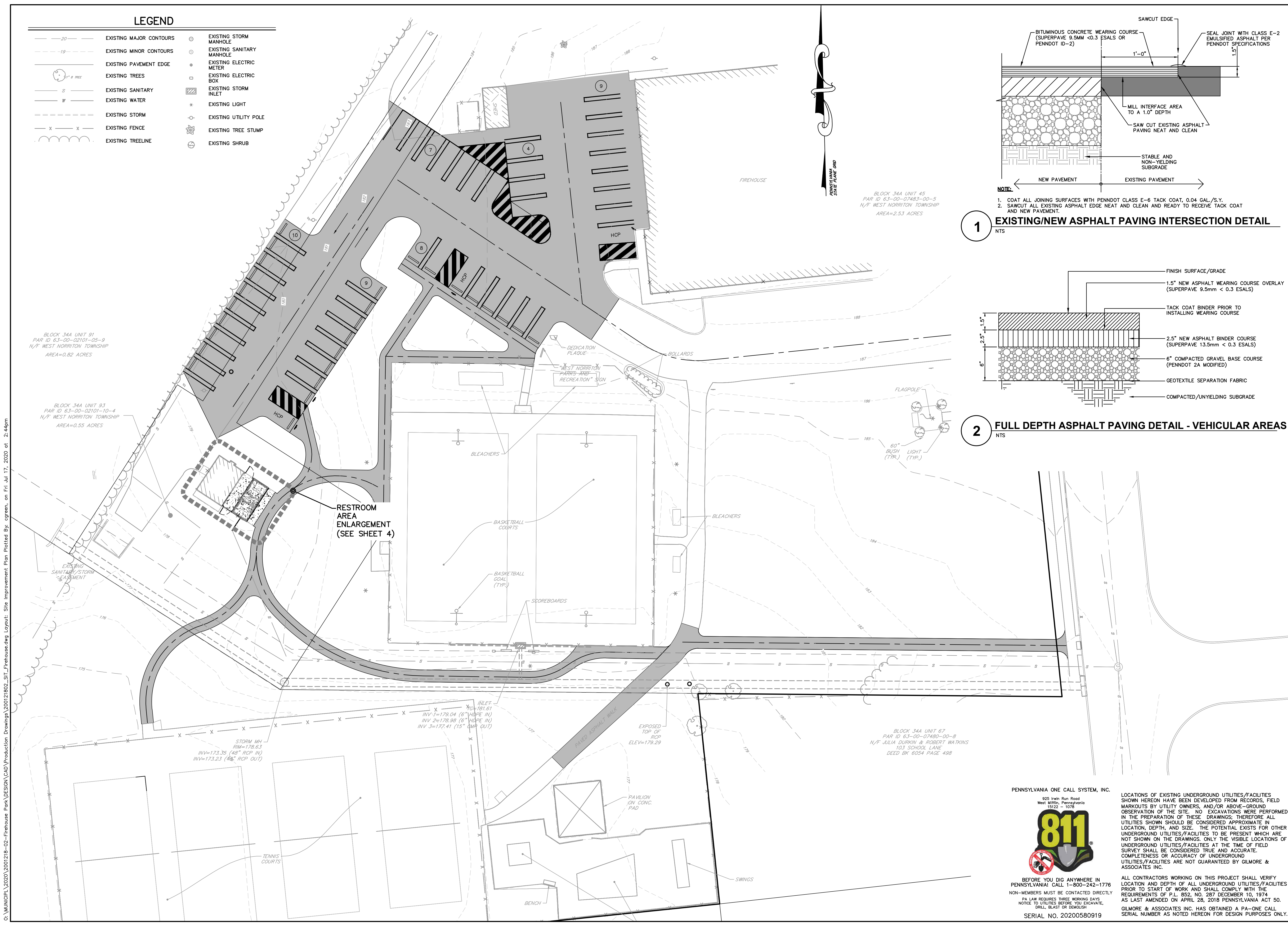

BLOCK 34A UNIT 91
PAR ID 63-00-02101-05-9
N/F WEST NORRITON TOWNSHIP
AREA=0.82 ACRES

BLOCK 34A UNIT 93
PAR ID 63-00-02101-10-4
N/F WEST NORRITON TOWNSHIP
AREA=0.55 ACRES

BLOCK 34A UNIT 45
PAR ID 63-00-07483-00-5
N/F WEST NORRITON TOWNSHIP
AREA=2.53 ACRES

BLOCK 34A UNIT 67
PAR ID 63-00-07480-00-8
N/F JULIA DURKIN & ROBERT WATKINS
103 SCHOOL LANE
DEED BK 6054 PAGE 498

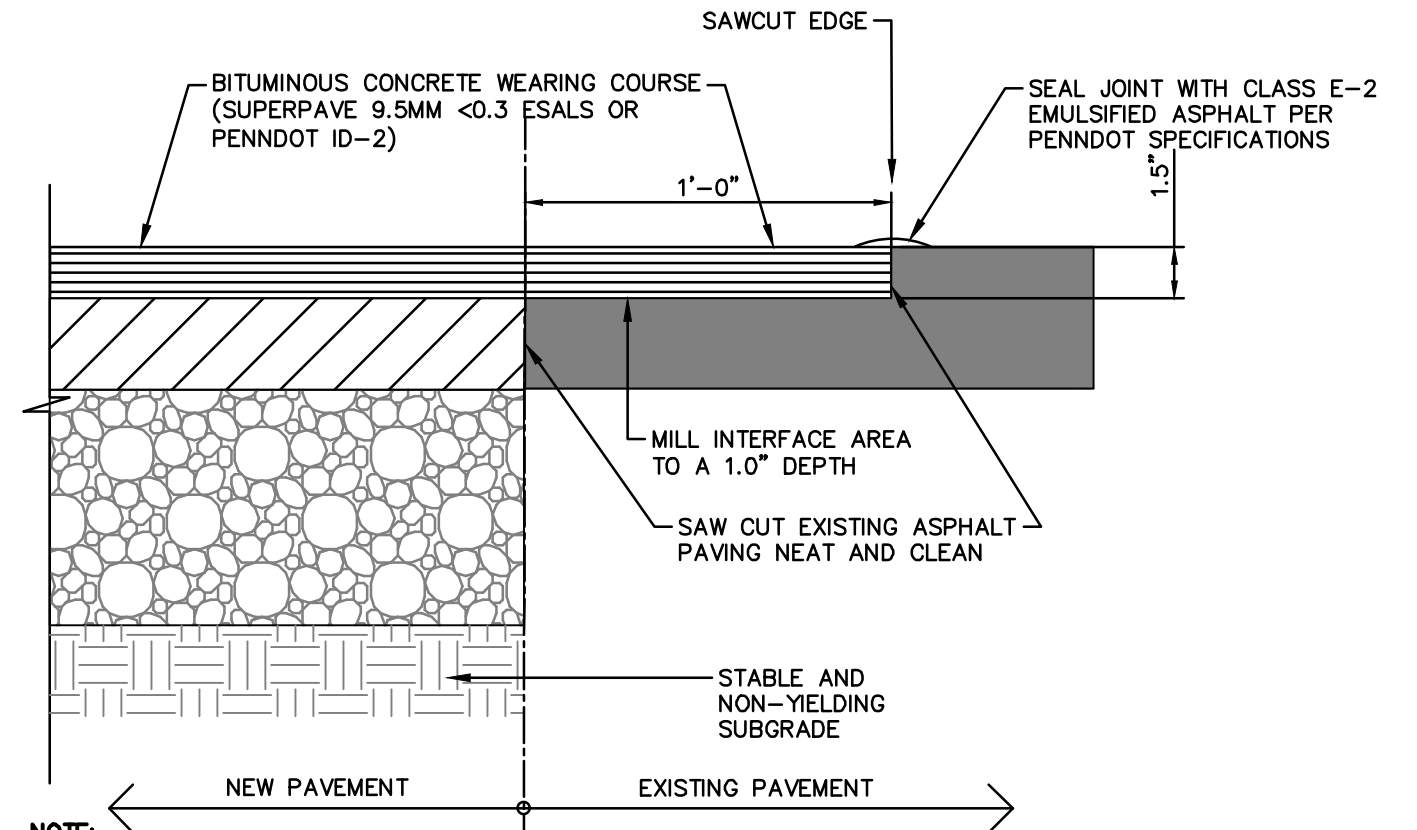

1 EXISTING/NEW ASPHALT PAVING INTERSECTION DETAIL
NTS

NOTE:
1. COAT ALL JOINING SURFACES WITH PENNDOT CLASS E-6 TACK COAT, 0.04 GAL./S.Y.
2. SAWCUT ALL EXISTING ASPHALT EDGE NEAT AND CLEAN AND READY TO RECEIVE TACK COAT AND NEW PAVEMENT.

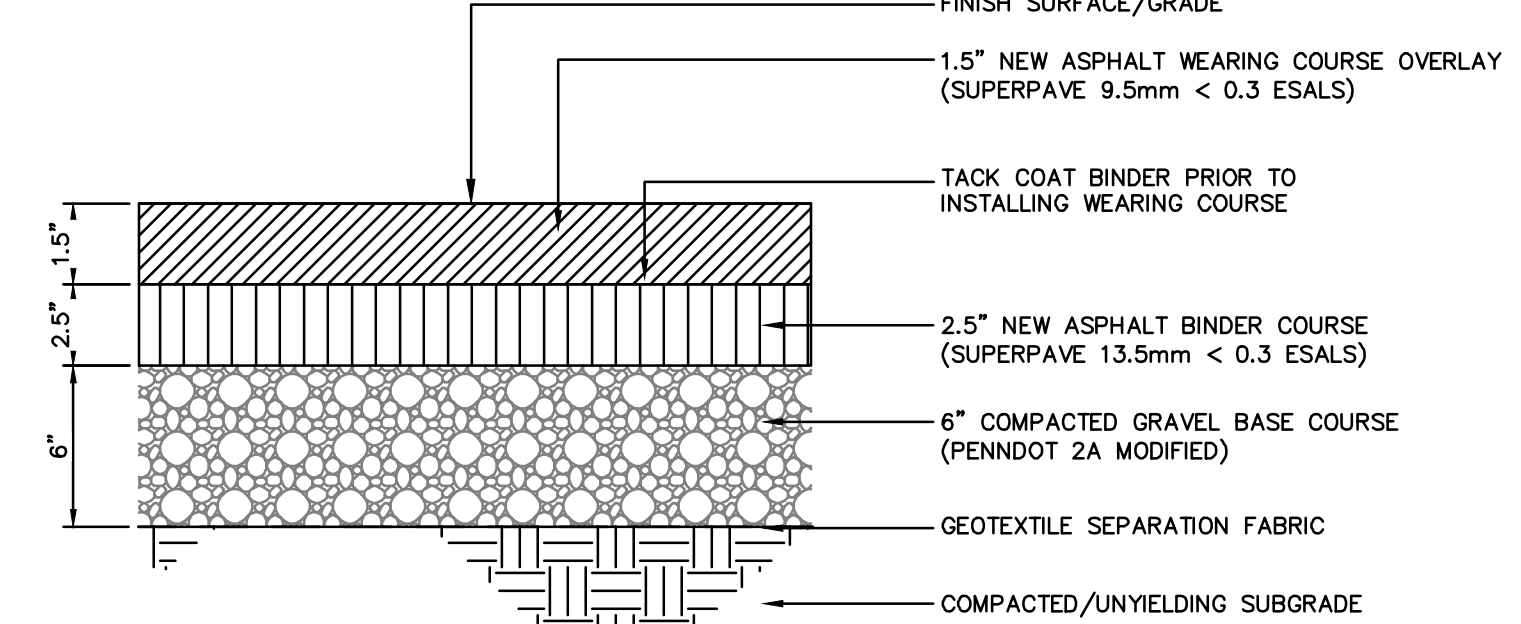

2 FULL DEPTH ASPHALT PAVING DETAIL - VEHICULAR AREAS
NTS

PENNSYLVANIA ONE CALL SYSTEM, INC.



BEFORE YOU DIG ANYWHERE IN PENNSYLVANIA! CALL 1-800-242-1776
NON-MEMBERS MUST BE CONTACTED DIRECTLY
PA LAW REQUIRES THREE WORKING DAYS
NOTICE TO UTILITIES BEFORE YOU EXCAVATE,
DRILL, BLAST OR DEMOLISH
SERIAL NO. 20200580919

LOCATIONS OF EXISTING UNDERGROUND UTILITIES/FACILITIES SHOWN HEREON HAVE BEEN DEVELOPED FROM RECORDS, FIELD MARKOUTS BY UTILITY OWNERS, AND/OR ABOVE-GROUND OBSERVATION OF THE SITE. NO EXCAVATIONS WERE PERFORMED IN THE PREPARATION OF THESE DRAWINGS; THEREFORE ALL UTILITIES SHOWN SHOULD BE CONSIDERED APPROXIMATE IN LOCATION, DEPTH, AND SIZE. THE POTENTIAL EXISTS FOR OTHER UNDERGROUND UTILITIES/FACILITIES TO BE PRESENT WHICH ARE NOT SHOWN ON THE DRAWINGS. ONLY THE VISIBLE LOCATIONS OF UNDERGROUND UTILITIES/FACILITIES AT THE TIME OF FIELD SURVEY SHALL BE CONSIDERED TRUE AND ACCURATE. COMPLETENESS OR ACCURACY OF UNDERGROUND UTILITIES/FACILITIES ARE NOT GUARANTEED BY GILMORE & ASSOCIATES INC.

ALL CONTRACTORS WORKING ON THIS PROJECT SHALL VERIFY LOCATION AND DEPTH OF ALL UNDERGROUND UTILITIES/FACILITIES PRIOR TO START OF WORK AND SHALL COMPLY WITH THE REQUIREMENTS OF P.L. 852, NO. 287 DECEMBER 10, 1974 AS LAST AMENDED ON APRIL 28, 2018 PENNSYLVANIA ACT 50.
GILMORE & ASSOCIATES INC. HAS OBTAINED A PA-ONE CALL SERIAL NUMBER AS NOTED HEREON FOR DESIGN PURPOSES ONLY.

GILMORE & ASSOCIATES, INC.
ENGINEERING & CONSULTING SERVICES
CORPORATE HEADQUARTERS
16 EAST BUILER AVENUE, SUITE 100, NEW BRITAIN, PA 18901 • (717) 345-4300 • www.gilmore-associates.com

ONLY THOSE PLANS INCORPORATING THE PROFESSIONAL SEAL SHOULD BE USED FOR THE CLIENT AND PROJECT DESIGNATED HEREON. MODIFICATION, REVISION, DUPLICATION OR USE WITHOUT THE WRITTEN CONSENT OF GILMORE & ASSOCIATES, INC. IS PROHIBITED. © COPYRIGHT 2020 GILMORE & ASSOCIATES, INC. ALL RIGHTS RESERVED.

NOT APPROVED FOR CONSTRUCTION

G&A

JOB NO.: 2001218-02
MUNICIPAL FILE NO.:
TAX MAP PARCEL NO.: XX
OWNER: WEST NORRITON TOWNSHIP
1630 W MARSHALL ST
JEFFERSONVILLE PA 19403
TOTAL AREA: 7.15 AC.
DATE: 03/20/2020
SCALE: 4
DESIGNED BY: JJK
DRAWN BY: CEG
CHECKED BY: CEG

SITE IMPROVEMENT PLAN
SITE IMPROVEMENT PLAN
FIREHOUSE PARK

WEST NORRITON TOWNSHIP, MONTGOMERY COUNTY, PENNSYLVANIA

REV.	DATE	BY	DESCRIPTION

SHEET NO.:
3 OF XX

C:\MUNICIPAL\2020\2001218-02-Firehouse Park\DESIGN\CAD\Production Drawings\200121802_SIT_Firehouse.dwg Layout: Site Improvement Plan Plotted By: cgreen, on Fri Jul 17, 2020 at 2:44pm